

KANREP NORRIS

INSTALLATION INSTRUCTIONS

Direct Drain Waste & Overflow

BW01



Kanrep Norris Plumbing Dist.

Hamilton, Ontario, Canada

1-800-793-2793

Info@kanrep.ca

www.kanrep.ca

BW04

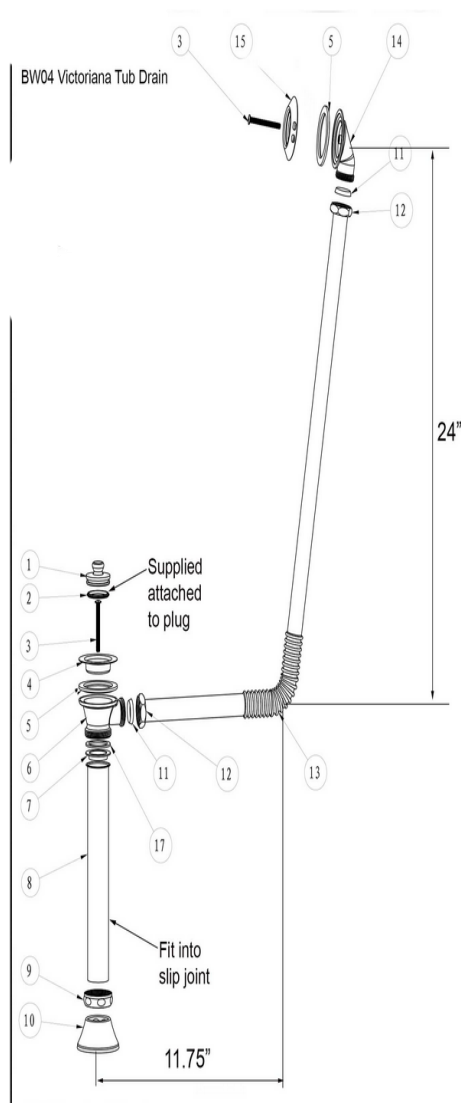

17	S3014-09	washer
15	S4012-04	overflow flange
14	S4039-02	overflow body
13	S4039D-01	overflow pipe
12	S4039-04	hex nut
11	S4028-09	compression gasket
10	S4039A-01	escutcheon
9	S3005-14	nut
8	S4039A-02	tail piece
7	S3006-10	washer
6	S4039-01	waste body
5	S4008-09	gasket
4	S4028-05	waste flange
3	S4028-14	screw
2	S4028-04	washer
1	S4039A-06	plug

Installation

- A.** Place #5 onto #14 and connect to #15 through the tub using #3. #3 will need cut to suit tub thickness.
- B.** Place #5 onto #6 and connect to #4 through the tub using #3. Apply a generous bead of silicon or putty under flange #4.
- C.** Measure and cut #13 to suit.
- D.** Connect #13 to #5 using #12 and #11.
- E.** Connect #13 to #14 using #12 and #11
- F.** Measure for #8 and cut pipe to suit.
- G** Fit #9 and #10 over #8 and push #8 into slip joint in floor.
- H.** Pull #8 up and connect to #6 using #9, include #7 and #17.
- J.** Tighten slip joint and cover with #10.
- K.** #1 is designed to be housed inside #15 when not in use.

Care and Maintenance

Minimum maintenance is required to maintain product finish. With proper maintenance your Rubex faucet will continually look like new. Special care should be taken when cleaning your faucet and the following suggestions will help extend your faucet life

- A.** Cleaning should be done regularly using a soft cotton cloth and warm water; then towel dry
- B.** Do not use cleaners that contain abrasives or harsh chemicals ;care should be taken in selecting cleaning supplies. Many cleaners contain detergents, ammonia, or other corrosive solvents that could damage your faucet finish.
- C.** Occasionally clean with a non-abrasive wax polish

Warranty

Kanrep Norris warrants the original purchase for a LIMITED LIFE TIME from original purchase that the product will be free of any manufacturing defects. Product will be replaced at no charge provided it has been installed in accordance to the attached installation instruction, used as recommended and not damaged due to misuse, abuse, faulty maintenance, accident, or other damage. Kanrep Norris is not responsible for replacement labour costs, or shipping charges, or damage incurred during installation, transportation, removal, repair, or replacements. All warranty claims are to be made to info@kanrep.ca and shall be accompanied by the original purchase receipt and photographs of the damage.